

The 4840 AUTO EQUALIZER™ is LCN's pneumatically powered MULTIDOOR solution. This low-energy automatic operator provides easy access for people with disabilities, or the elderly. Designed primarily for manual opening applications that occasionally require automatic opening.

Certifications	Grade 1 - ANSI A117.1, A156.19, UL 10C 228, ADA, 100 Hour Salt Spray, Meets BAA - Buy American Act	Cover	Metal, standard
Body Construction	<ul style="list-style-type: none"> ■ Cast Iron Body ■ Full Complement Bearing ■ 1-1/2" Diameter Piston ■ 3/4" Diameter Double Heat Treated Pinion Journal 	Fasteners	Wood and machine screws Specify door thickness if over 1-3/4"
Fluid	All Weather Fluid	Mounting	Parallel arm (Push Side)
Handing	Non-Handed	Arms	Extra heavy duty, standard Cush-n-stop and spring cush, optional
Size	Adjustable Spring Size 1-5	Finishes/Colors/ Powder Coat	<ul style="list-style-type: none"> ■ Aluminum (689) ■ Statuary Bronze (690) ■ Light Bronze (691) ■ Black (693) ■ Dark Bronze (695) ■ Brass (696) ■ Custom colors optional
Warranty	2 years		<ul style="list-style-type: none"> ■ Optional SRI primer - powder coat only ■ Optional plated finishes* <p><i>*End caps are black</i></p>

**Special
Templates**

Customized installation templates or products may be available to solve unusual applications. Contact LCN Product Support for assistance.

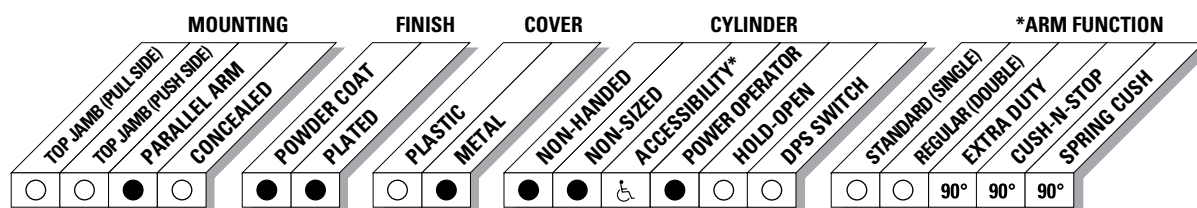

● AVAILABLE
○ NOT AVAILABLE

♿ Meets ADA requirements (power mode).
* See individual series for maximum manual opening.

4840 Series Auto Equalizer

Mounting details

Parallel Arm (Push Side) Mounting

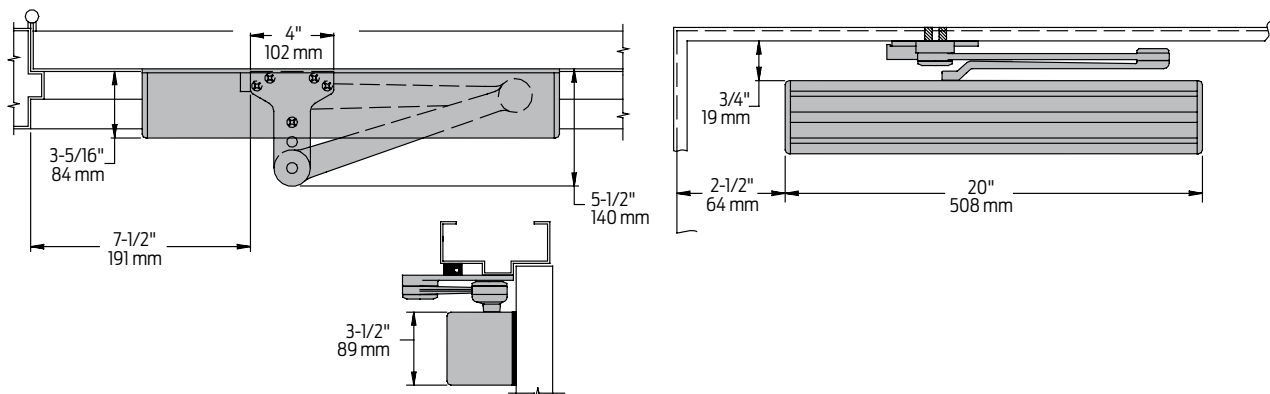

Butt Hinges	Should not exceed 5" (127 mm) in width
Auxiliary Stop	Recommended when CUSH-N-STOP or SPRING CUSH arms are not used
Clearance	EDA or CUSH shoes is 5-1/2" (140 mm) from door face
Top Rail	Minimum 4-1/8" (105 mm). 6" minimum top rail for screw not to show in glass
Head Frame	(Flush) requires PA SHOE ADAPTER, 4840-419
Stop Width	Minimum 1" (25 mm)
Blade Stop	Clearance requires 1/2" (13 mm) BLADE STOP SPACER, 4840-61
System Diagram	See "AUTOMATIC OPERATORS" section pages 7-8 for typical system wiring, and pages 28-29 for electrical and pneumatic data for control boxes
Maximum Opening	<ul style="list-style-type: none"> ■ Maximum power opening is 90° with all arms ■ Maximum manual opening is 105° with EDA or SPRING CUSH arms ■ Maximum manual opening is 100° with CUSH-N-STOP arm <p><i>NOTE: For CUSH-N-STOP or SPRING CUSH arm installations with maximum opening less than listed above, consult factory for Special Template</i></p>

Notes:

- Multi-door solution utilizing 10,000,000 cycle heavy duty door closer
- Requires control boxes with integral compressor and control box using auxiliary air supply
- See CONTROL BOX pages 28-29 and actuators and accessories, pages 115-131
- Guard rails/safety mats not required

Cylinders



4841-3971
Cast Iron Cylinder Assembly

- Non-handed
- Standard



4841-3071
Cast Iron Cylinder Assembly

- Non-handed
- Mounting plate
- Standard

Cover



4840-72MC
Metal Cover

- Non-handed
- With black end caps
- Standard

Arms



4840-3077EDA
Extra Duty Arm

- Non-handed
- Features forged solid steel main arm and forearm for potentially abusive installations
- Standard



4840-3077CNS
Cush-n-Stop Arm

- Non-handed
- Features forged solid steel main arm and forearm with stop in soffit shoe
- Optional



4840-3077SCNS
Spring CUSH Arm

- Non-handed
- For abusive applications features forged solid steel main arm and forearm with spring loaded stop in soffit shoe
- Optional

Installation accessories



4840-30
CUSH Shoe Support

- Provides anchorage for fifth screw used with EDA and CUSH arms, where reveal is less than 3-1/16" (78 mm)



4840-61
Blade Stop Spacer

- Required to lower parallel arm shoe to clear 1/2" (13 mm) blade stop



4840-419
PA Flush Panel Adapter

- Provides horizontal mounting surface for parallel arm shoe on single rabbeted or flush frame

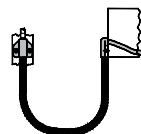

4840-459
Door Loop Kit

- Surface mounted, flexible metal loop transfers pressurized air via pneumatic tubing from frame to closer end cap
- Extra caps allow tubing to run on frame surface or concealed in the frame.



4840-460
Pneumatic Transfer Hinge

- Transfers pressurized air via pneumatic tubing from frame to door leaf for fully concealed installations
- Preparation of a raceway is required from the hinge stile of the door to the top rail for concealment of the pneumatic tubing within the door leaf